

please note: the internal tube will rattle when the radiator is unpacked. This is normal and will not happen once the radiator is installed.

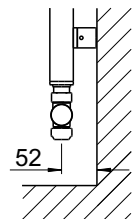
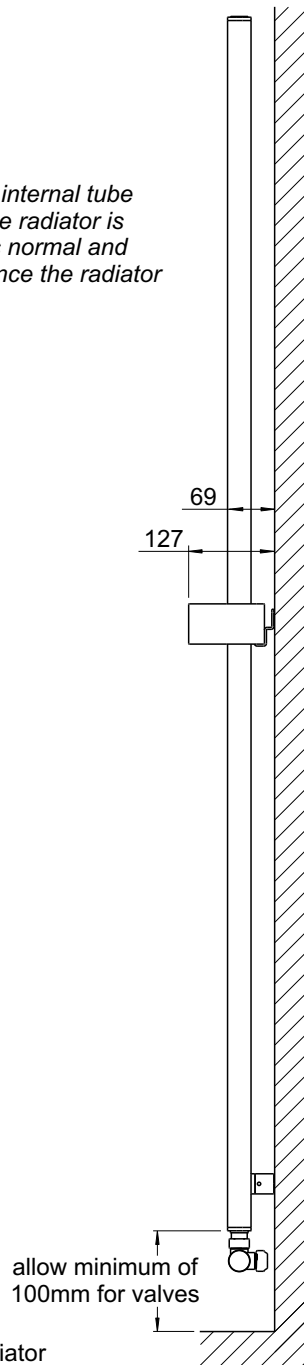

straight or angled valves are supplied with this radiator (see separate sheet for fitting instructions)

straight valve (to floor)

All dimensions shown are in millimetres

Test pressure: **8 BAR**
 Max working pressure: **6 BAR**
 Max working temperature: **90° C**

Heat output determined in accordance with EN 442

Construction: **35mm x 200mm extruded aluminium section**
plastic chrome end trims
 Connections: **1/2 inch BSP underside tapping**
 Manufactured for Bisque in Italy

Model	Output $\Delta T=50K$ Watts	Output $\Delta T=60K$ Watts	n	Water Content litres	Weight kg	Height $\pm 2mm$	Length $\pm 2mm$	Connection Centres $\pm 2mm$	Fixing Centres $\pm 2mm$
SV 180-30	421	531	1.32	1.05	8.57	1810	300	38	847

Tools & Material Required

- Suitable valves
- PTFE tape
- Silicone thread sealant
- Tape measure
- Screwdriver - crosshead
- Spanner - 8mm
- Electric drill
- Masonry drill bit - 8mm diameter
- Spirit level
- Stepladder (for taller radiators)

please note: the internal tube will rattle when the radiator is unpacked. This is normal and will not happen once the radiator is installed.

Key	Component	Qty
A	Valve Assembly (straight or angled)	1
B	Air Vent - 1/2"	1
C	Wall Plug	3
D	Screw - Hex Head, M5 x 10	1
E	Hanger Plate	1
F	Screw - Csk Head, 4mm dia x 50mm	3
G	Bracket	1
H	Bracket Boss	1
I	Grub Screw	1
J	Allen Key	1

Assembly Instructions

Sufficient PTFE tape must be applied to valve-tail thread prior to its installation.
 Silicone thread sealant should be applied to all threaded components manufactured with 'O-rings'.

- Fit valve assembly (A) to radiator, referring to separate instructions.
 - Fit air vent (B).
 - Accurately mark out bracket holes on wall using spirit level.
 - Drill three 8mm diameter holes to a minimum depth of 60mm & insert wall plugs (C).
 - Screw M5 x 10 screw (D) into hanger plate (E) but ensure no thread protrudes into U-shaped channel.
 - Screw hanger plate (E) into wall plugs (C) with 4mm diameter x 50mm screws (F).
 - Fix bracket (G) onto wall using 4mm diameter x 50mm screw (F) into wall plug (C).
 - Screw bracket boss (H) onto threaded stud on radiator by hand, taking care not to overtighten..
 - Hang radiator on plate (E), at the same time sliding boss (H) into bracket (G).
 - Secure radiator in position by tightening grub screw (I) using Allen key (J) and M5 screw (D) using 8mm spanner.
 - Plumb radiator to heating circuit.
- This radiator should be installed onto a central heating system that has been cleaned/flushed and contains water treatment and inhibitor suitable for a **mixed metal system** in accordance with BS7593.

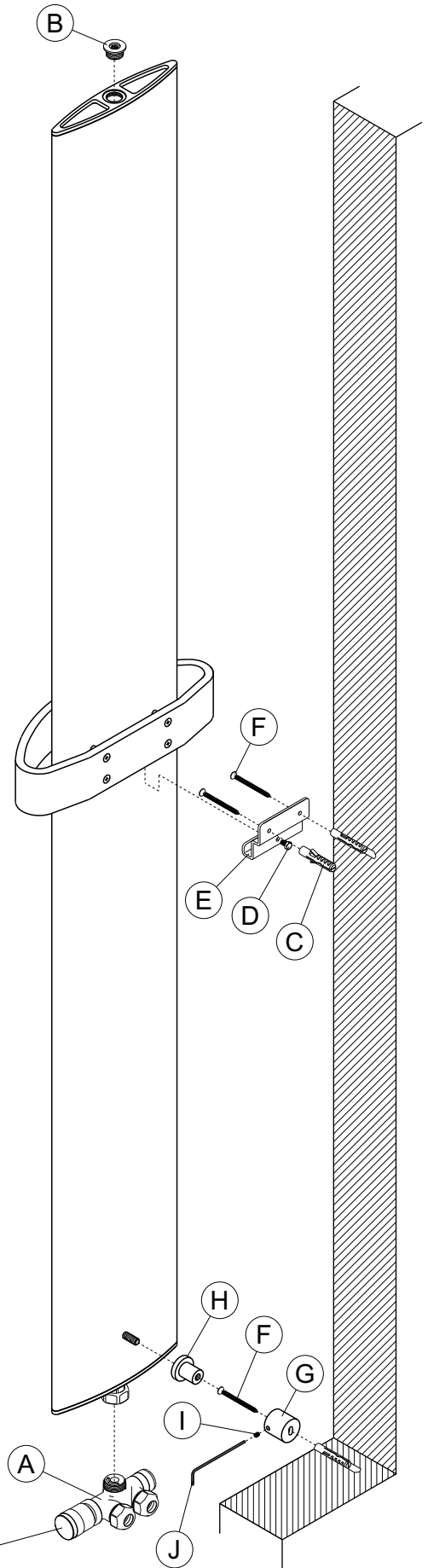

straight or angled valves are supplied with this radiator (see separate sheet for fitting instructions)

Tools & Material Required

Adjustable Spanner

Key	Component	Qty
A	Valve Body	1
B	Compression Fitting (15mm)	2
C	Balancing Cap	1
D	Flow Control Cap	1

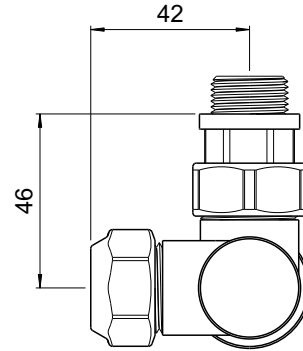
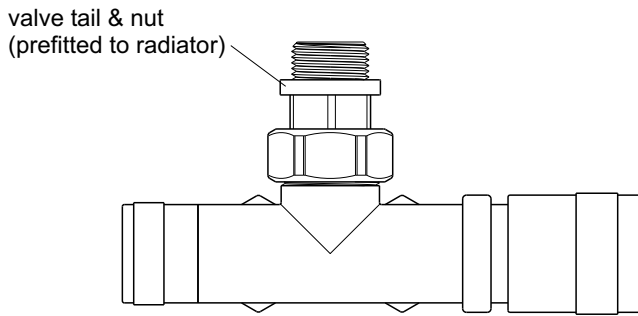

**Angled Valve
(to wall)**

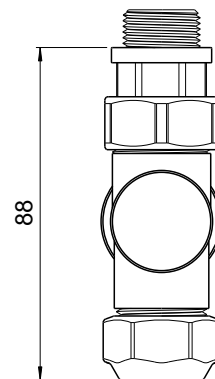
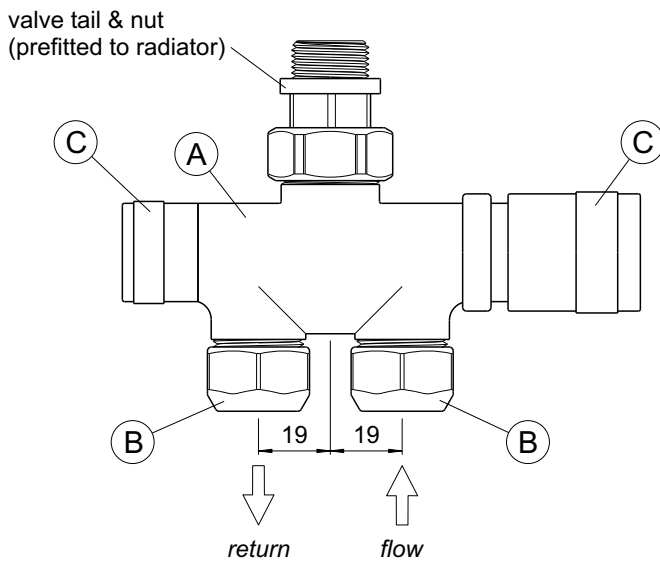
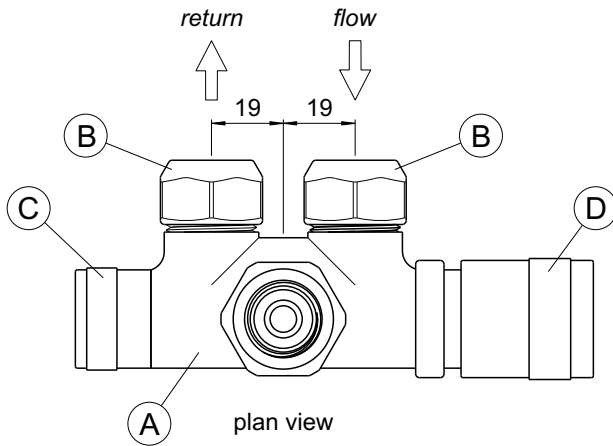

**Straight Valve
(to floor)**

Assembly Instructions

Fit compression fitting components (B) to 15mm pipe tails & valve body. (see exploded view below)

Screw valve body (A) to valve tail that is pre-fitted to radiator and tighten compression fittings (B) with a torque of 35-45 Nm to valve body (A).

(If fitting thermostatic head, refer to additional instructions below.)

After filling and venting radiator, remove cap (C) and adjust balancing control to balance radiator.

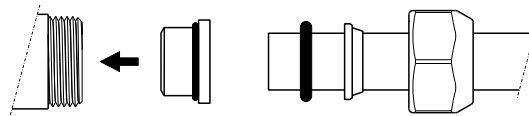

exploded view of compression fitting

Fitting Thermostatic Head

Remove flow control cap (D) by unscrewing anti-clockwise by hand. With an adjustable spanner, unscrew internal adjuster & remove. *Note: retain these for use during any future maintenance.*

Set reading on thermostatic cap to '6' and tighten cap fully onto valve body (A).

After filling and venting radiator, remove cap (C) and adjust balancing control to balance radiator.

Please note: thermostatic valve must only be installed on the flow side of system.

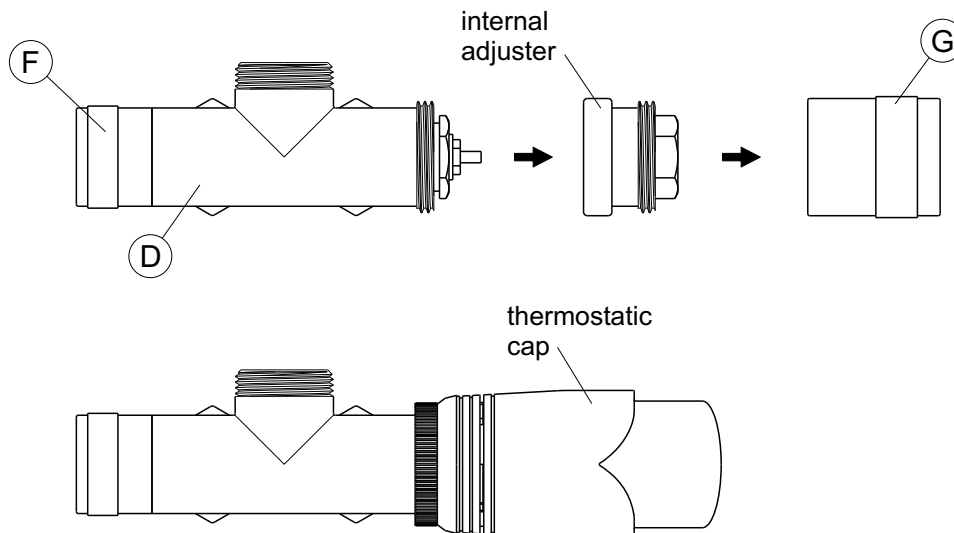

Further technical information regarding valves (sheet TDS3.1) can be found on our website at www.bisque.co.uk or by calling and requesting a faxed or posted copy on **01225 478500** (Bath) or **0207 328 2225** (London).